

detail : 1

detail : 2

detail : 3

site plan

general notes:
 - in event of any ambiguity please inform the office before commencing work.
 - all dimensions to be checked for site suitability before commencing work.
 - all dimensions and levels are in meter.
 - all dimensions to be read , please do not scale.
 - all dimensions are without finishes.
 - all levels are without finishes.
 - beam sleeves shall be co-ordinated with respective consultants drawing before casting

specific notes:
 - 15mm single coat wire plaster for all external stone clad areas.
 - 25mm double coat mala plaster for all external surface.
 - 15mm single coat wire plaster for all internal walls, to be finished with 12mm gypsum plaster.
 - 75mm thk floor finish above all r.c.c. slab.
 - 10mm x 10mm drip mould for all openings and semi covered area 50mm from external surface.
 - 50mm skirting in internal areas.
 - staircase risers are equally divided into mentioned parts with reference to both levels.

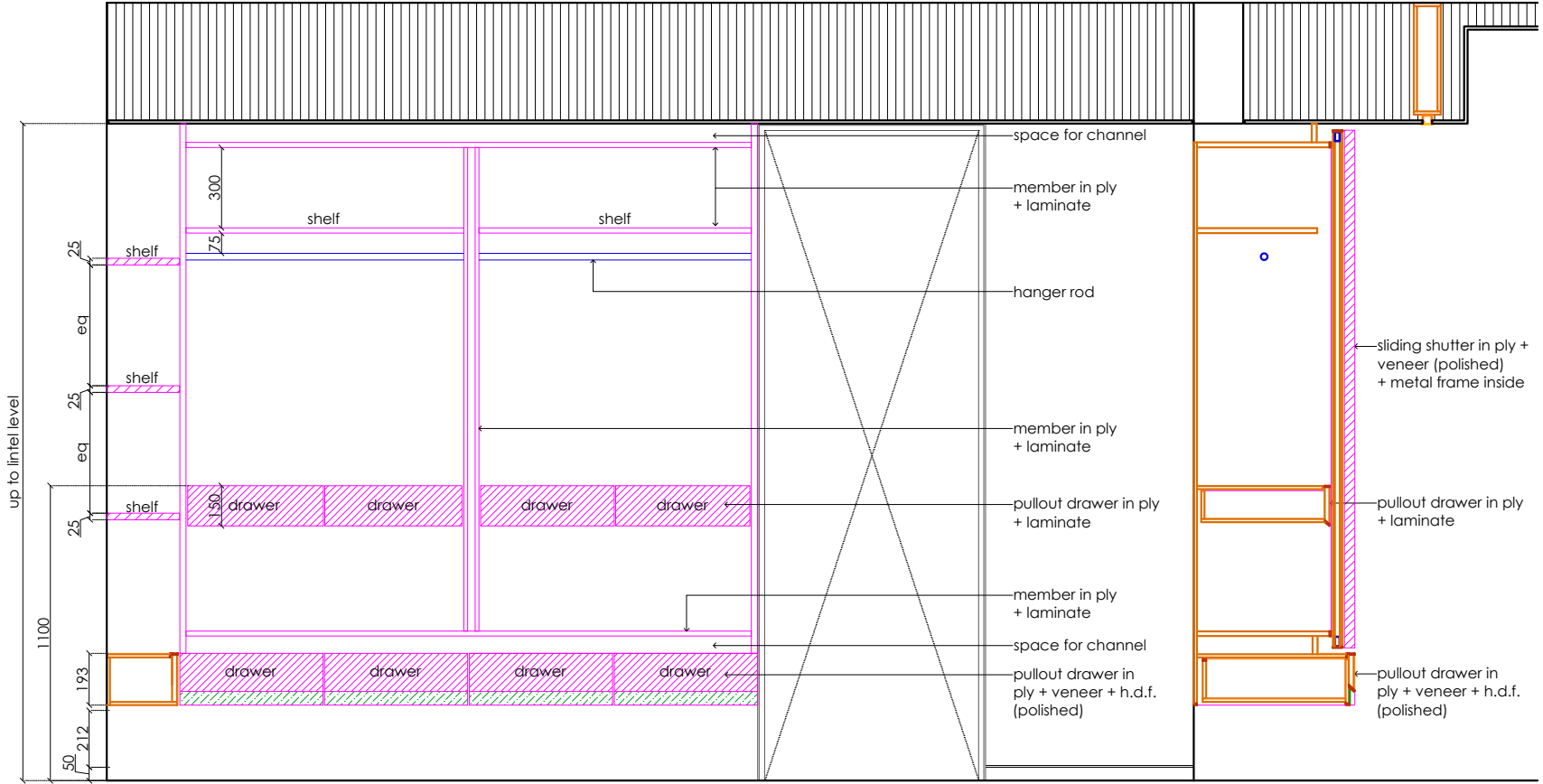

internal elevation

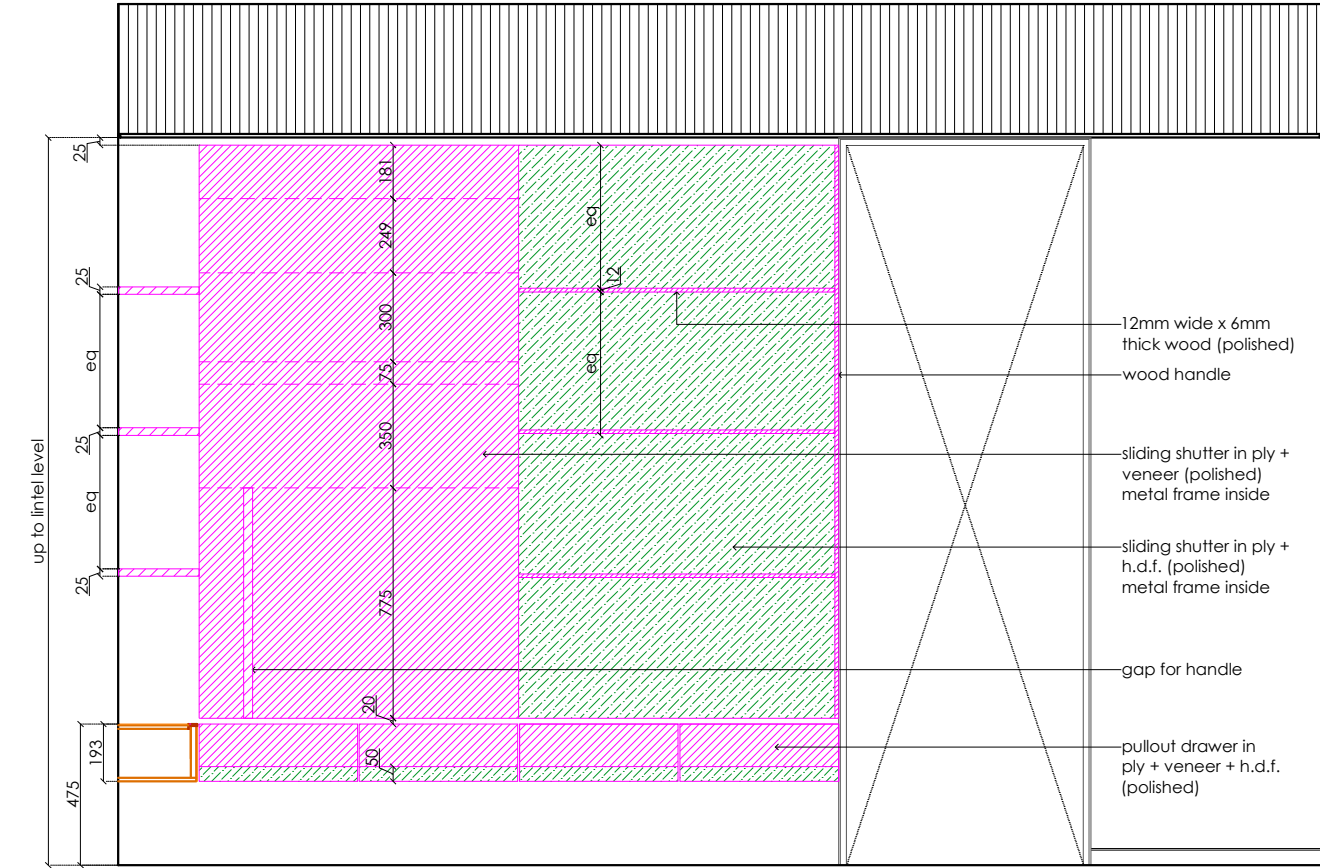

elevation

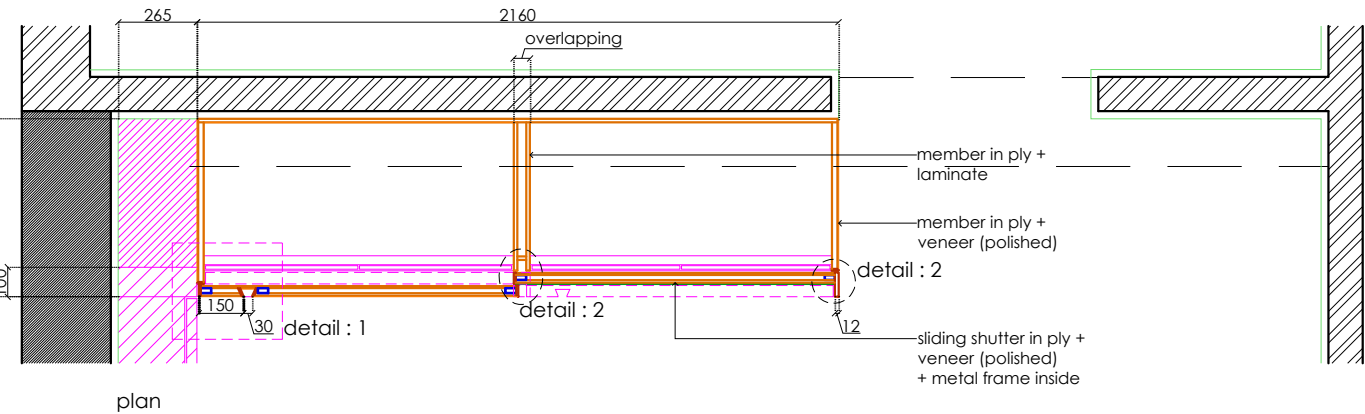

plan

no.	revision	date